

FITTING INSTRUCTIONS

- Remove the original double seat from the vehicle. Retain the 4 floor bolts.
- Remove spare wheel and any necessary interior trim panels from the vehicle.
- Centre TS1111 (3) on the 2 centre factory threaded holes in the vehicle floor and insert M10 x 50mm fine thread bolts (11), but do not tighten.
- Ensuring TS1111 (3) is centred, mark and drill the 4 outer 10mm holes through vehicle floor, using the plate as a guide.
- The 2 holes required for the far left seat leg bolts are covered by the sheet metal floor from factory and need to be used as part of the installation. Underneath the vehicle, locate the 2 far passenger side dome nuts. A 3mm drill bit is to be used through the centre holes in these dome nuts, to locate them from above inside the vehicle. Once they are located from above, use a step drill to drill the 3mm locator holes out to 10mm.
- Using TS1093-01 (8) as a template, align the plate with the appropriate wall recesses on both driver and passenger side. Using a step drill, drill all 4 10mm holes (2 either side).
- Install all 4 wall brackets (2 driver side TS1170 (4), TS1171 (5)) and 2 passenger side TS1172 (6), TS1173 (7), as well as location specific M10 underfloor plates. Do not tighten bolts until seats are fitted and aligned.
- Install 4 seat legs TS1092 (2), using the 4 original Toyota M10 fine thread seat leg bolts on the outer 2 legs and the 4 M10 x 75mm hex bolts (9) on the 2 inner legs. Install the 4 M10 underfloor plates (18) onto the 4 M10 x 75mm bolts.

Ensure the seat legs are fitted in the correct orientation. Again, do not tighten bolts yet.
- Once all wall brackets and seat legs are fitted, position both double seats (1) and ensure the M10 x 25 seat bolts (14) align with all appropriate holes.
- Fit all 12 M10 x 25mm seat bolts (14) with M10 flat washer (15) and M10 nyloc nut (16).
Ensure seat is as far back in the seat leg and bracket slots as possible.
- The original Toyota fire extinguisher bracket is to have 2 10mm holes drilled in it to match the 2 centre holes in TS1111 (3). This allows the fire extinguisher to be relocated, centrally under the seats and out of the way.
- Tighten all nuts and bolts, ensuring both double seats are even and aligned properly.
- Remove factory Toyota seatbelt from the rear driver side corner, as it is no longer needed. Fit the supplied black rubber grommet (21) over the bolt hole.

| ITEM NO. | PART NO. | QTY. | DESCRIPTION | PACKED BY |
|----------|--------------------|------|--|-----------|
| 1 | - | 2 | INTERLINE DOUBLE SEAT | |
| 2 | TS1092 | 4 | H300 HIACE COMMUTER SEAT LEG | |
| 3 | TS1111 | 1 | H300 COMMUTER 14 SEATER CENTRE FLOOR PLATE | |
| 4 | TS1170 | 1 | PASSENGER SIDE REAR BRACKET | |
| 5 | TS1171 | 1 | PASSENGER SIDE FRONT BRACKET | |
| 6 | TS1172 | 1 | DRIVER SIDE REAR BRACKET | |
| 7 | TS1173 | 1 | DRIVER SIDE FRONT BRACKET | |
| 8 | TS1093-01 | 2 | DRIVER/PASSENGER SIDE WALL PLATE | |
| 9 | 10X75M 88 ZPB | 4 | M10 x 75mm HEX BOLT | |
| 10 | 10X50M 88 ZPSS | 5 | M10 x 50mm HEX HEAD BOLT | |
| 11 | 10.1.25X50M 88 ZPB | 2 | M10 x 50mm METRIC FINE HEX BOLT | |
| 12 | 10M SW | 11 | M10 SPRING WASHER | |
| 13 | 10M ZPW | 9 | M10 FLAT WASHER | |
| 14 | 10X25M SEGE | 12 | M10 x 25 BOLT - SEGE 4030X | |
| 15 | 10X25X3M SEGE | 12 | M10 x 25 X 3mm FLAT WASHER - SEGE 4030X | |
| 16 | 10M NYLN | 12 | M10 NYLOC NUT | |
| 17 | TS533A | 10 | SPACER Ø22.2 x 12.6mm | |
| 18 | TS371 | 8 | M10 UNDERFLOOR PLATE 95 X 40 | |
| 19 | T1-211 | 1 | M10 UNDER FLOOR PLATE - 77x25x8mm | |
| 20 | 1052900 | 1 | SHORT CAP SC701 BLACK 8 x 25mm | |
| 21 | 0561 6681 | 1 | 21x30x24 BLANKING GROMMET | |
| 22 | (NOT SUPPLIED) | 4 | ORIGINAL TOYOTA SEAT LEG BOLTS | |
| 23 | (NOT SUPPLIED) | 1 | ORIGINAL TOYOTA WALL BRACKET M10 NUT | |
| 24 | (NOT SUPPLIED) | 1 | FIRE EXTINGUISHER | |
| 25 | (NOT SUPPLIED) | 1 | FIRE EXTINGUISHER BRACKET | |
| 26 | PK134 | 1 | FITTING INSTRUCTIONS | |

- Fit black rubber cap (20) over the exposed original seat stud in the rear driver side corner.
- Refit any interior trim panels that were removed during installation and vacuum up any metal shavings.
- Refit spare wheel.

IMPORTANT INFORMATION FOR INSTALLERS

Aftermarket seats and swivels sold by Techsafe Seating have been tested by an approved testing authority in Australia and found to meet the strength and performance requirements of the appropriate standards. Aftermarket seats and swivels should only be installed by competent and experienced personnel. Aftermarket seats and swivels in some state jurisdictions may require certification by a qualified certifying engineer. In all instances professional engineering advice should be sought to ensure the suitability of the integration of the seat or swivel into the original vehicle structure and to consider for any effect the modification may have on that vehicles compliance with legislated standards. As the manufacturer and seller of this product has no control over the end use or the fitment to the vehicle, the manufacturer and seller accepts no responsibility or liability for any malfunction of the product or the vehicle occupant safety systems as a direct or indirect result of faulty installation or unauthorized repair or modification to this product. Modification of the seat, swivel or installation kit should not be made without certification by a qualified engineer or manufacturers written consent. Where components of the installation kit are modified to better suit the specific nature of the installation, these must be substituted with components of equivalent or greater strength. Good engineering practice should be evident at all times including the use of metal spacers between brackets and the floor pan, appropriately torqued anchorage bolts, rust inhibitors on drilled holes and adhesive sealant used on underfloor backing plates.

PROPRIETARY AND CONFIDENTIAL

THE INFORMATION CONTAINED IN THIS DRAWING IS THE SOLE PROPERTY OF TECHSAFE. ANY REPRODUCTION IN PART OR AS A WHOLE WITHOUT THE WRITTEN PERMISSION OF TECHSAFE IS PROHIBITED.



56 Lower Mountain Road
HERVEY BAY QLD 4655
PH 07 4128 3337
email: technical@techsafeseating.com.au
web: techsafeseating.com.au

PRODUCT INTERLINE QUAD SEAT (2 X DOUBLES)

VEHICLE/PROJECT
TOYOTA HIACE COMMUTER H300 SLWB
PEOPLE MOVER 05/2019 ON

| | | |
|---|---------------------------------------|-----------------|
| DESIGN APPROVAL No. 20200022R002Rev0 | COMPLIES WITH VSB 5 (3.0 - Rev. 1) | REV 1 |
| DATE 19/08/2019 | DWG No. PK134 | |

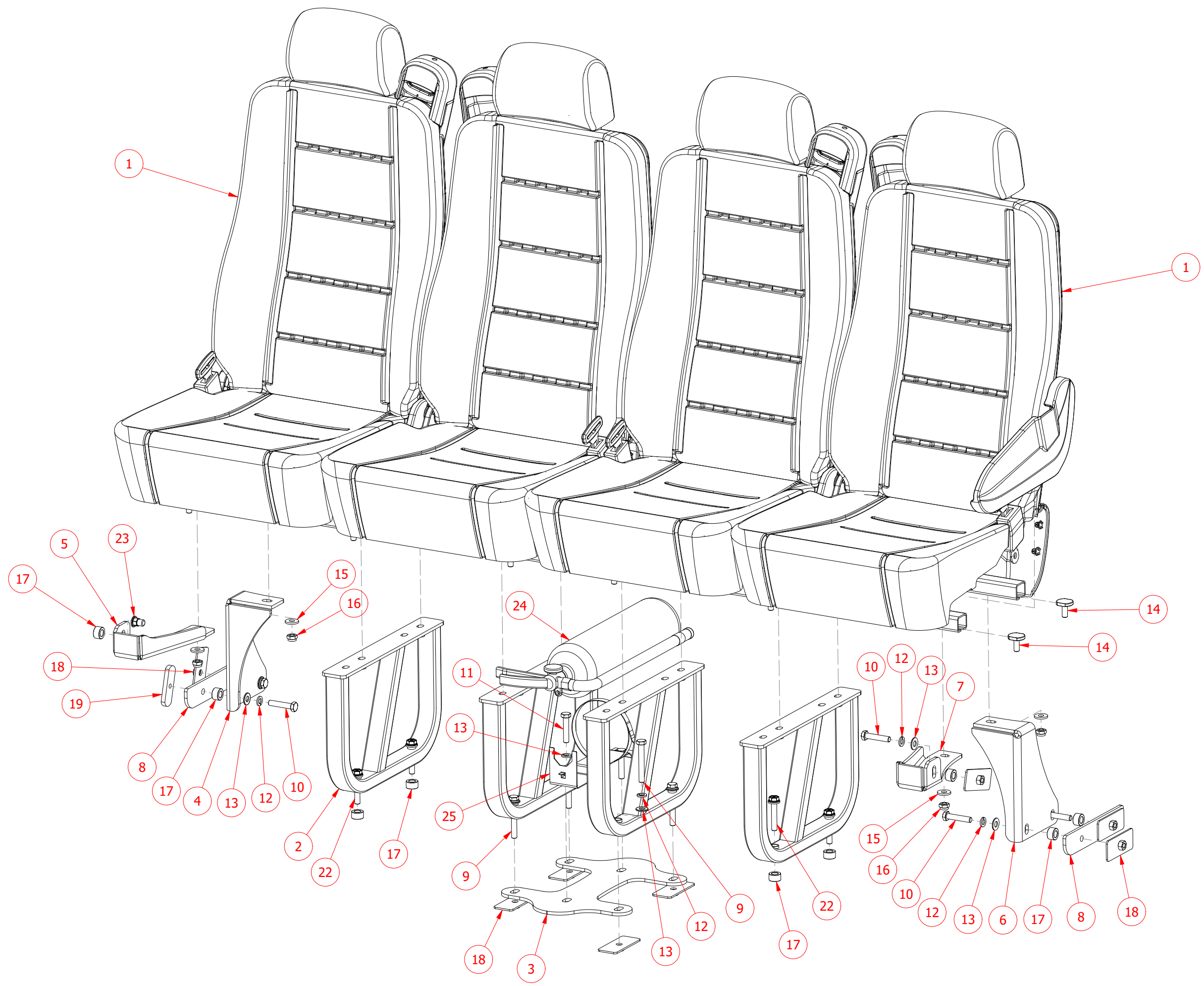

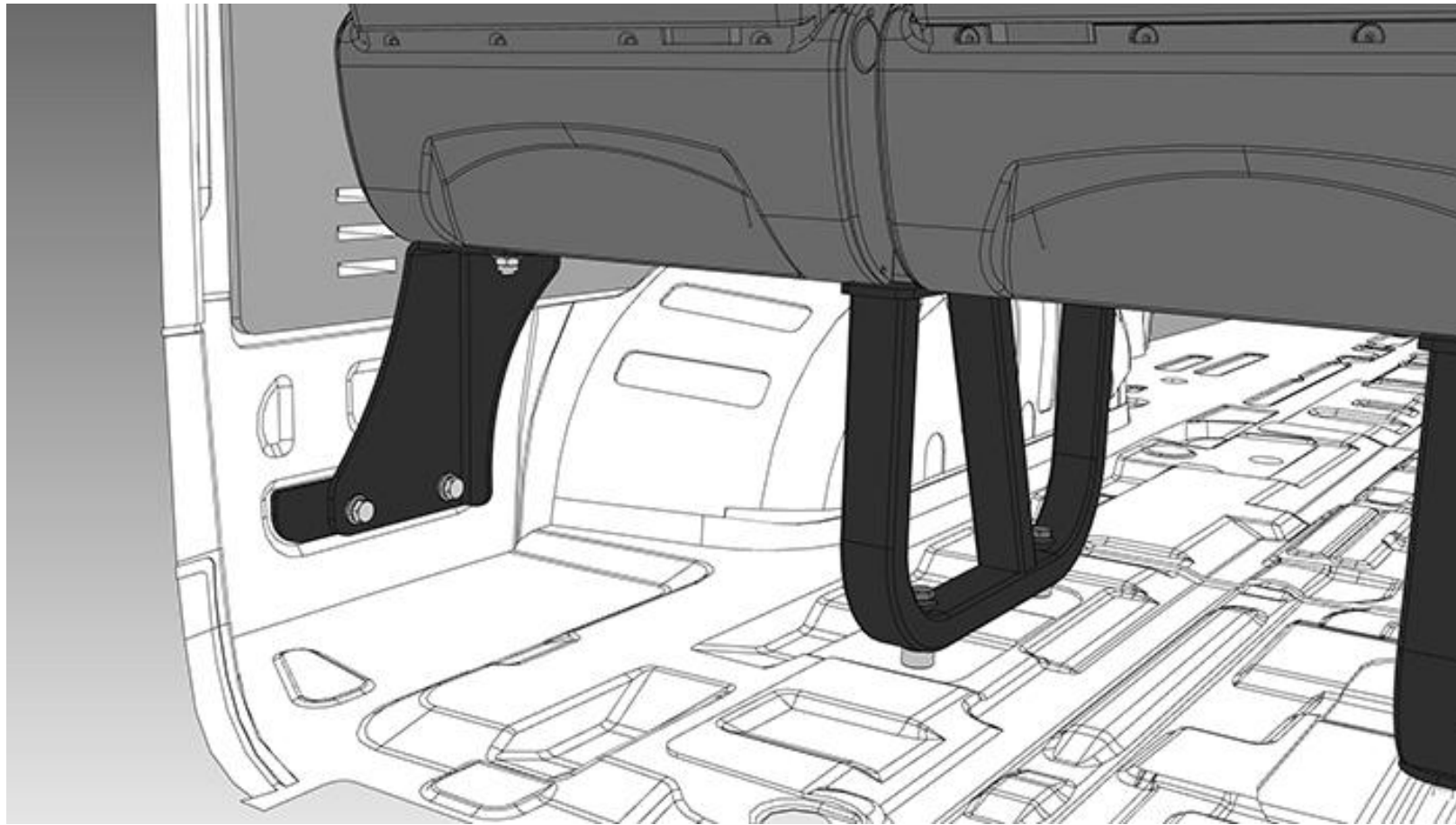

REAR LEFT CORNER

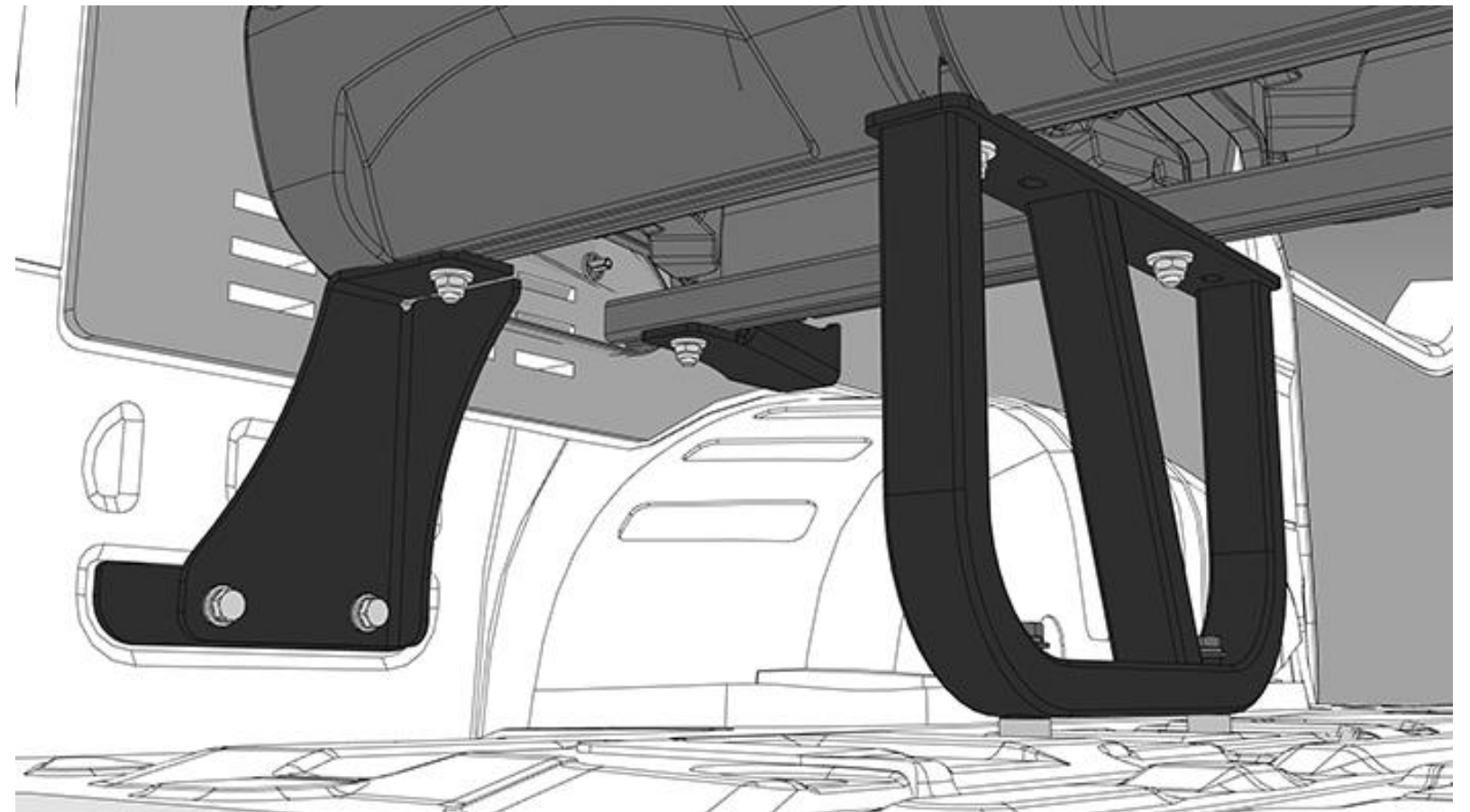

REAR LEFT CORNER (UNDERSIDE)

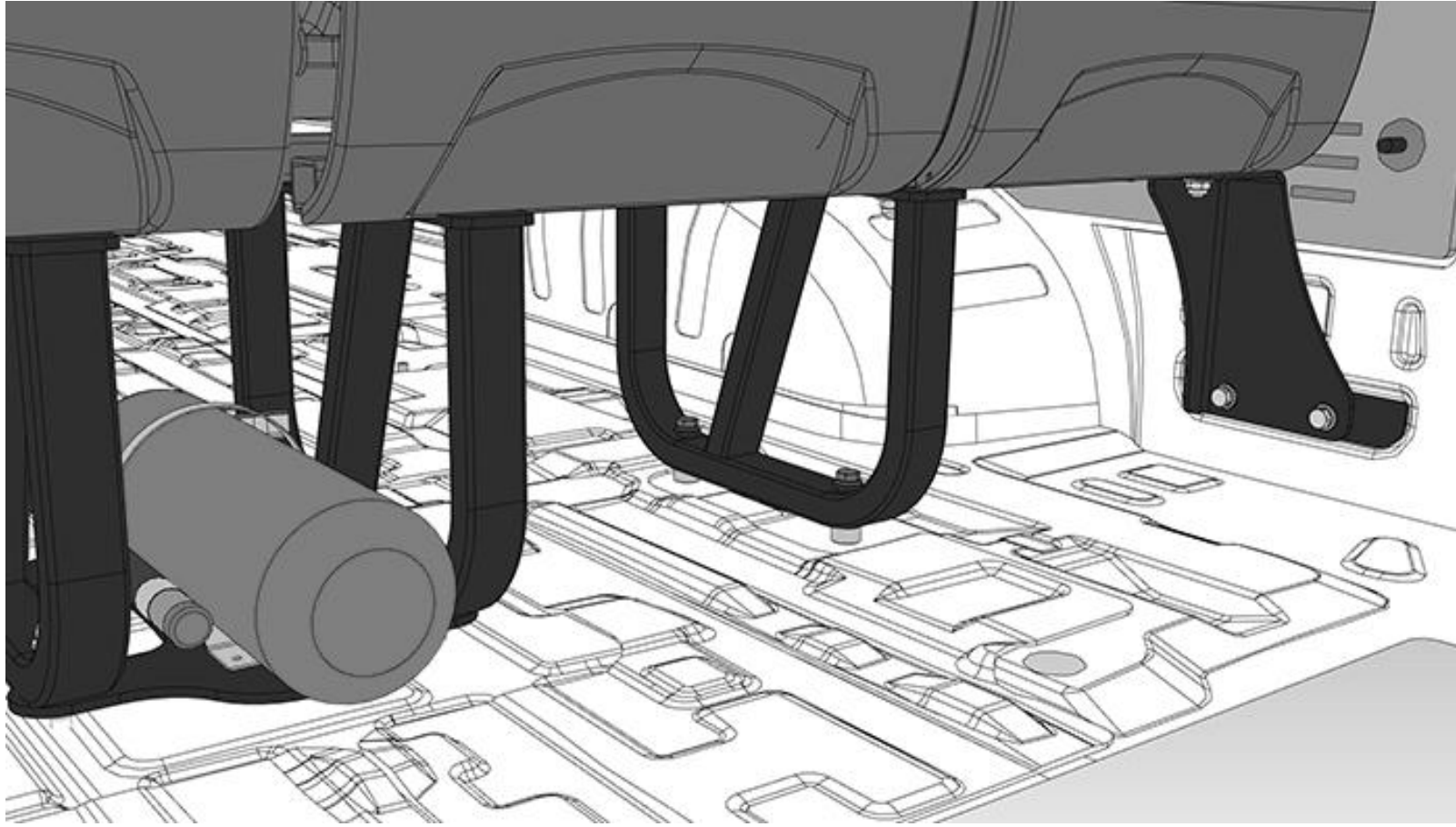

REAR DRIVER SIDE CORNER

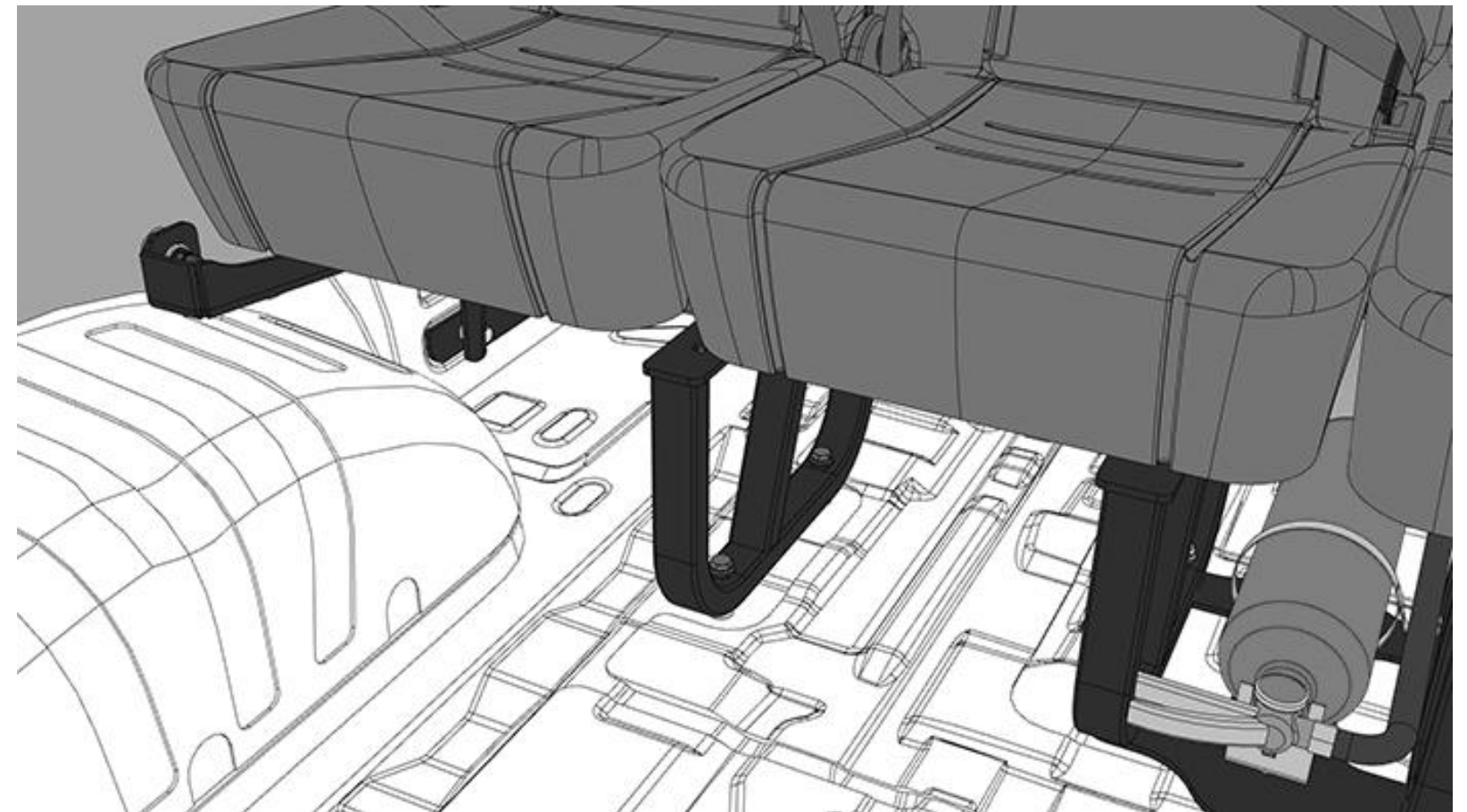

REAR DRIVER SIDE CORNER (TOP VIEW)